

# Decks and Equipment

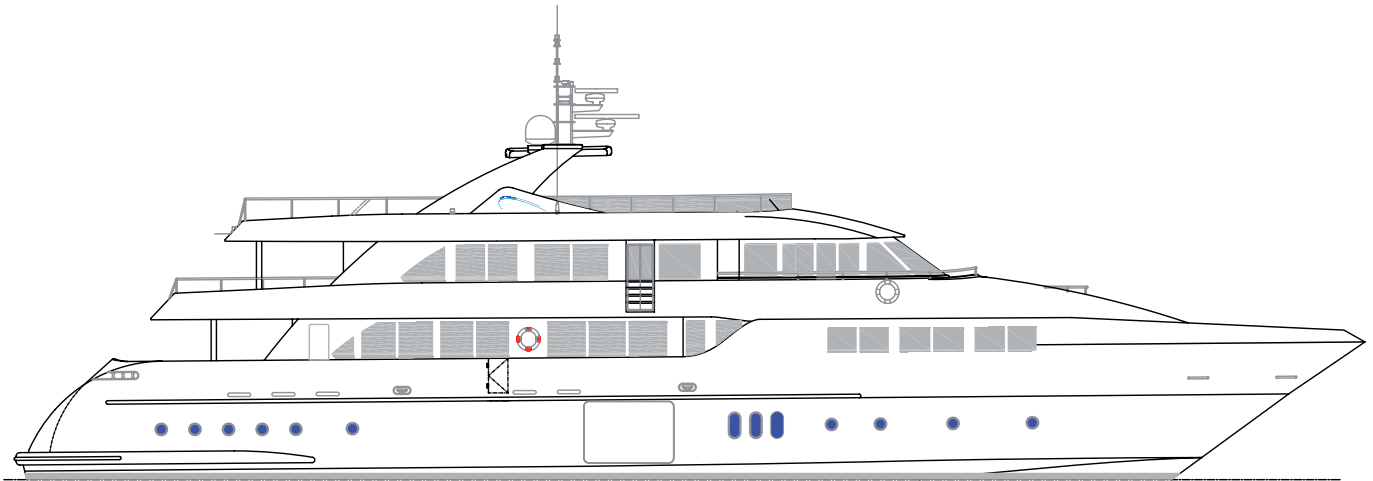

Enough storage

All guest cabins have showers and separate toilets partly with bidet and jacuzzi

Airconditioning in all areas

Floor heating in alle cabins and most of the areas etc.

usw.

Full AV equipment in all cabins and areas

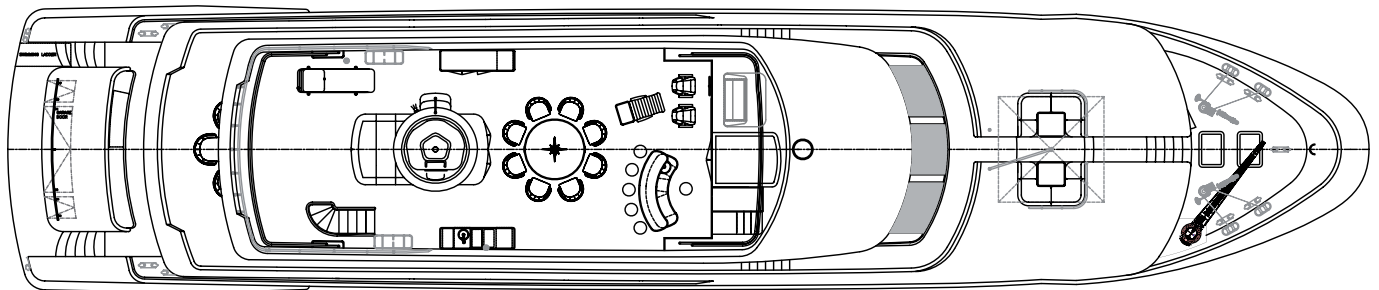

Fully equipped 2nd bridge with 2 helmsman chairs

Big jacuzzi with attached sunbathing area

Big enlargeable table for up to 10 guests

Bar area, fully equipped

Barbeque, fridges, icemaker, dishwasher

5 sunbeds in the aft section

2 hydraulic biminis

2 electric awnings

Full AV equipment

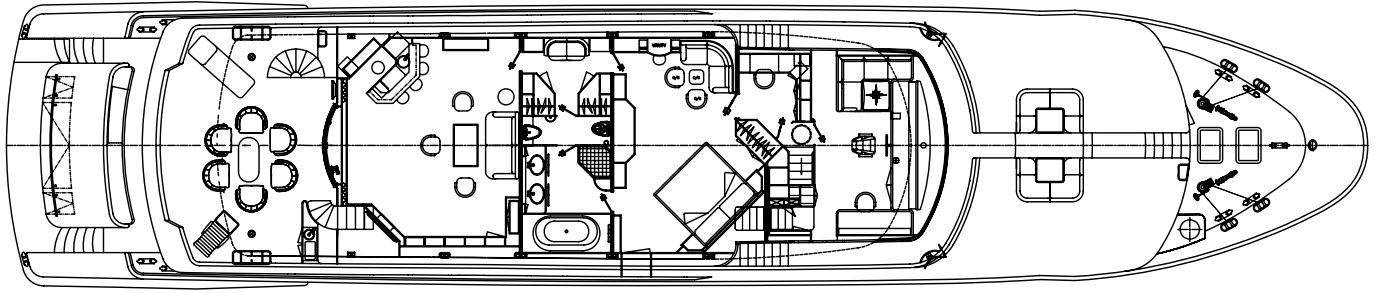

Big owners sundeck aft with barbeque galley, TV

Comfortable owners lounge with fully equipped bar, electric chimney, 50" TV, etc.

Dressingroom

Owners bedroom with french balcony, comfortable large bathroom with jacuzzi

Office

Wheelhouse

Seating and sunbathing area with umbrella in front of the wheelhouse

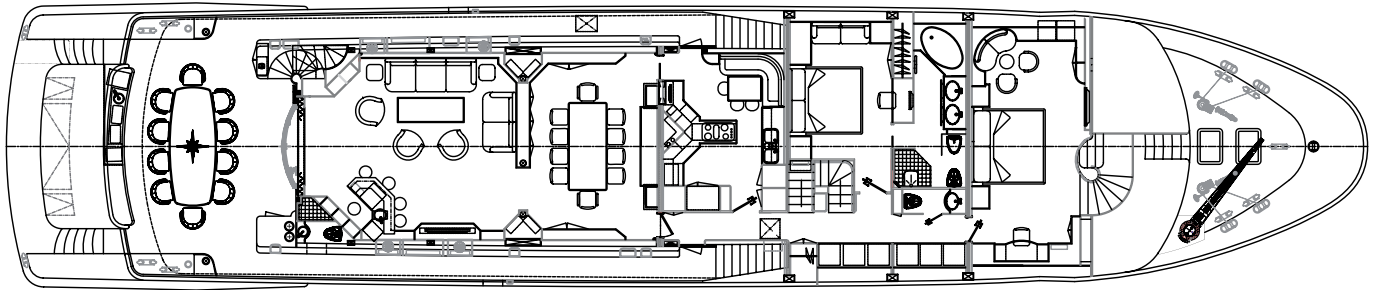

Big sundeck aft with barbeque, icemaker, fridge, dishwasher, TV

Dining table for 10 guests

Exterior bathroom

Salon with comfortable seating area, fully equipped bar, electric chimney, 50" TV

Dining area with enlargeable dining table comfortable for 10 guests

Galley with seating area, fully equipped with big cooking top, american refrigerators, freezers, fully automatic coffee machine,

3 wine-refrigerators, washing machine / drier

Separate guesttoilet

Guest cabin 1 with enlarged bathroom with jacuzzi

VIP-cabin on two levels with large comfortable bathroom and jacuzzi

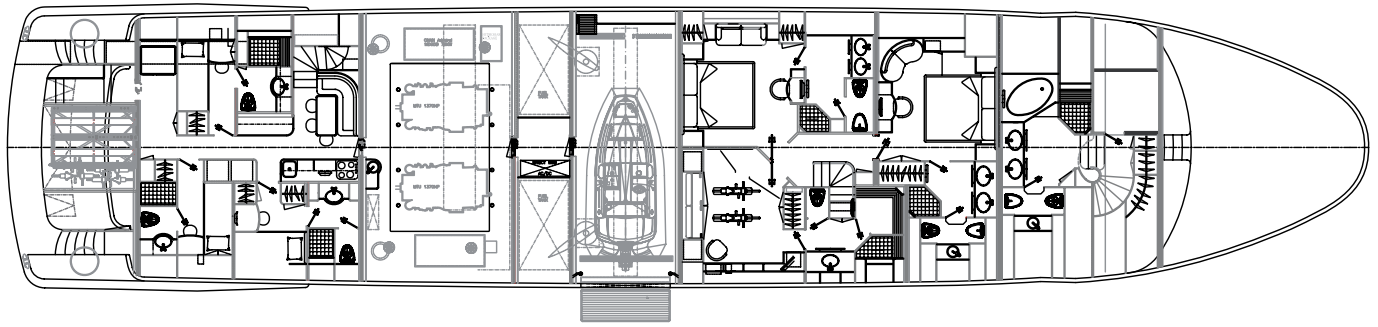

Big aft garage

Diving room

Engine room

Tender / Jet Ski garage fwd of engine room on full width with side entrance

Crew area, 3 twin cabins, crew mess and galley

3 guest cabins all with ensuite bathroom. One guest cabin is convertible as gym, steam sauna, shower and toilet ist attached to this cabin